

# SPECIFICATION SHEET

## PPSU PEX Fitting - Tee

Rev. 2.5 Issued: Dec. 20, 2018



### Materials

Solvay Acudel 22000 BK937 /NT15 or Radel 5100 BK937/NT15

### Product Information:

The components covered by this specification are intended for use in residential building and commercial building only.

The applications include:

- (a) Plumbing systems - Hot and cold potable water distribution systems
- (b) Sealed central heating/under floor heating systems
- (c) Radiant Heating and Cooling Systems
- (d) Maximum Working temperature/Pressure  
210°F (99°C) at 150psi (1034kPa)

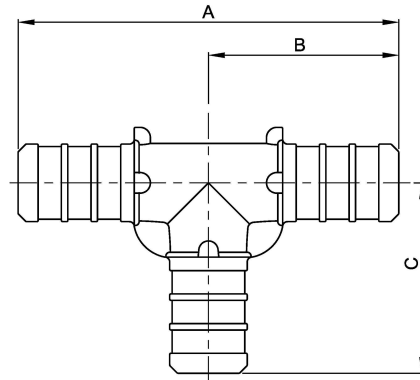

Pex ends of fitting are used to connect to Pex tubing

Drawing / PN#	A ( mm )	B ( mm )	C ( mm )	Weight ( g )	Description
T4010/T-333-W/B	55.6	27.8	27.8	3.9	3/8" PEX TEE
T4020/T-444-W/B	59	29.5	29.5	6.3	1/2" PEX TEE
T4030/T-666-W/B	64	32	32	14	3/4" PEX TEE
T4040/T-888-W/B	77.5	38.75	38.75	25.9	1" PEX TEE
T4080/T-446-W/B	64	32	29.5	8.3	1/2" x 1/2" x 3/4" PEX TEE
T4090/T-644-W/B	61	29.5	32	8.5	3/4" x 1/2" x 1/2" PEX TEE
T4090B/T-644-W/B	61.5	29.5	32	9.2	3/4" x 1/2" x 1/2" PEX TEE
T4100/T-646-W/B	64	32	32	11.1	3/4" x 1/2" x 3/4" PEX TEE
T4110/T-664-W/B	59	29.5	30.5	9.9	3/4" x 3/4" x 1/2" PEX TEE
T4115/T-668-W/B	59	29.5	38.75	15.8	3/4" x 3/4" x 1" PEX TEE
T4130/T-866-W/B	68	34	33.7	19.4	1" x 3/4" x 3/4" PEX TEE
T4140/T-884-W/B	68	34	33.7	19	1" x 1" x 1/2" PEX TEE
T4150/T-886-W/B	68	34	33.7	20.5	1" x 1" x 3/4" PEX TEE
T4160/T-868-W/B	71.5	37.5	38.75	23	1" x 3/4" x 1" PEX TEE

### Installation:

Use listing copper or stainless steel ring and Pex tubing for assembly.

### Standard

CSA B137.5; ASTM F2159, F877; NSF61; NSF14; AB1953

### Remark:

Each fitting has "NCI" trademark;

Additional testing, requirements or certification are required if fittings are used other than residential building and commercial building.

### Listing

IAPMO file #5932, N5932, 6020, 7653

### Contact Information:

**National Craft Industries, Inc.**  
11F-5, No. 266, Sec. 1, Wen Hua 2nd Road,  
Lin Ko District, New Taipei City 244, Taiwan,  
R.O.C.

**TEL:886-2-2609-6891**

**FAX:886-2-2609-7767**

**E-mail: [nci.johnson@nationalcraft.biz](mailto:nci.johnson@nationalcraft.biz)**

**[www.ppsu-fittings.com](http://www.ppsu-fittings.com)**

**NOTE:**

Our PPSU pex fittings have been made white or black in color so that any harmful chemical or UV exposure can be witnessed, and suspect fittings can be removed from use.

Do not expose PPSU fittings to any foreign substance that includes but is not limited to VOC (volatile organic chemical) compounds, paints, solvents, glues, cleaners and disinfectants. PPSU pex fittings that are exposed to these types of substances are at risk of failures.

PPSU pex fittings must be protected from UV exposure, which can damage them. UV exposure during storage, handling and installation should not exceed 15 days.