

SPECIFICATION SHEET

PPSU PEX Fitting – Swivel Elbow with Wing Nut

Rev. 2.5 Issued: Dec.20, 2018



Materials

- (a) Solvay Acudel 22000 BK937 /NT15 or Radel R5100 BK937/NT15
- (b) Swivel nut is made from Nylon
- (c) Washer is made from either Santoprene ,NBR or EPDM
- (d) Stainless Steel Washer made by 300 series.

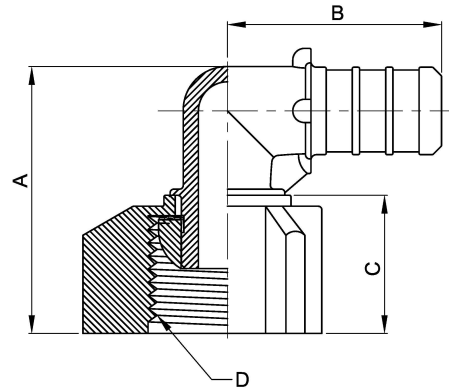

Product Information:

The components covered by this specification are intended for use in residential building and commercial building only.

The applications include:

- (a) Plumbing systems - Hot and cold potable water distribution systems
- (b) Sealed central heating/under floor heating systems
- (c) Radiant Heating and Cooling Systems
- (d) Maximum Working temperature/Pressure
210°F (99°C) at 150psi (1034kPa)

Drawing / PN#	A (mm)	B (mm)	C (mm)	D	Weight (g)	Description
T2099-W/E-40I-W/B	36.7	29.5	19	1/2" NPSM	12.5	1/2" PEX x 1/2" Female NPSM Swivel Elbow With Wing Nut

Installation:

1. Use listing copper or stainless steel ring and Pex tubing for assembly.
2. Tight Lock force should be 30 lbs/inch with tolerance +/- 2.5 lbs/inch.
3. Swivel elbow design need match supply fitting and supply fitting's specification should according to 4.4.7 figure 2-a of ASME A112.18.1-2011 /CSA B125.1-11. No burrs, flash, sharp edge is allowed on sealing surface of shanks.

Standard

CAN/CSA B137.5; ASTM F2159, F877;
NSF61; NSF14; AB1953

Remark:

Each fitting has "NCI" trademark;

Additional testing, requirements or certification are required if fittings are used other than residential building and commercial building.

Listing

IAPMO file #5932, N5932, 6020, 7653

Contact Information:

National Craft Industries, Inc.
11F-5, No. 266, Sec. 1, Wen Hua 2nd Road,
Lin Ko District, New Taipei City 244, Taiwan,
R.O.C.
TEL:886-2-2609-6891
FAX:886-2-2609-7767
E-mail: nci.johnson@nationalcraft.biz
www.ppsu-fittings.com

NOTE:

Our PPSU pex fittings have been made white or black in color so that any harmful

chemical or UV exposure can be witnessed, and suspect fittings can be removed from use.

Do not expose PPSU fittings to any foreign substance that includes but is not limited to VOC (volatile organic chemical) compounds, paints, solvents, glues, cleaners and disinfectants. PPSU pex fittings that are exposed to these types of substances are at risk of failures.

PPSU pex fittings must be protected from UV exposure, which can damage them. UV exposure during storage, handling and installation should not exceed 15 days.